

QUANTUM® QG05

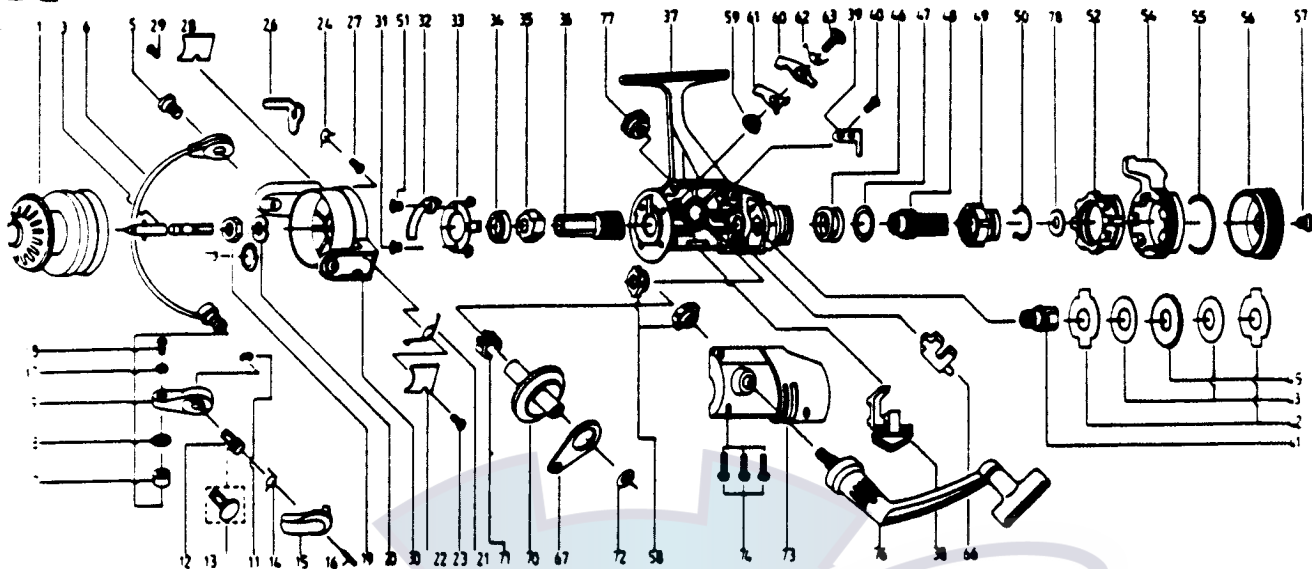

KEY PART NO. NO.	DESCRIPTION	PRICE	KEY PART NO. NO.	DESCRIPTION	PRICE
1 GT321	SPOOL ASSEMBLY	5.68	42 ST030	REAR DRAG WASHER "A"	1.27
3 BT315	MAIN SHAFT ASSY	2.59	43 ST039	REAR DRAG WASHER "B"	1.43
5 BT048	BAIL HOLDER SCREW	.69	45 ST066	CLICK GEAR	.52
6 BT347	BAIL ARM ASSY.	5.44	46 ST031	REAR DRAG COIL SPR.	1.14
7 VB004	LINE ROLLER	1.09	47 ST046	REAR DRAG ADJ. WSHR.	1.03
8 VB016	LN ROLLER BUSHING	.63	48 ST112	REAR DRAG NUT	1.09
9 ST007	ARM LEVER	1.72	49 ST017	SLIDING SCREW	1.03
11 BT002	E-CLIP	.85	50 BT033	BACK CLICK CLAW	.39
12 BT113	TRIGGER HOLDER	.58	51 ST182	KICK LEVER GUIDE SCR	.39
13 BT111	ARM LEVER CAP	1.14	52 GT093	FIGHTING FULL SCREW	1.66
14 BT114	TRIGGER SPRING	.52	54 GT094	FIGHTING LEVER	4.02
15 BT115	TRIGGER	1.43	55 GT095	FIGHTING LEVER	.85
16 BT116	TRIGGER PIN	.39	56 GT032	REAR DRAG CAP	2.24
17 VB102	BAIL AXLE WASHER	.29	57 VB079	DRAG SCREW	.92
18 VB108	BAIL AXLE SCREW	.58	58 BT013	BODY COVER BUSHING	.69
19 VB006	ROTOR NUT	.58	59 BT014	A/R CLAW BUSHING	.69
20 ST065	ROTOR RETAINER	.58	60 BT063	A/R CLAW (N)	.75
21 ST022	BAIL SPRINGS	.69	61 ST064	A/R CLAW (S)	.75
22 ST087	BAIL SPRING COVER	.69	62 BT061	A/R CLAW SPRING	.39
23 BT085	BAIL SPR.COVER SCREW	.63	63 ST089	A/R CLAW SCREW	.34
24 ST049	KICK LEVER SCREW	.58	66 ST081	PIN SLIDER	.80
25 ST019	KICK LEVER	1.14	67 ST025	OSCILLATING SLIDER	1.27
27 ST037	KICK LEVER SCREW	.34	70 BT012	DRIVE GEAR	3.55
28 ST024	KICK LEVER COVER	.46	71 ST086	SLIDING SPRING	.46
29 ST085	BAIL SPR.COVER SCREW	.63	72 RB026	CRANK GEAR SHIM	.29
30 ST009	ROTOR ASSY	5.85	73 GT323	BODY COVER ASSEMBLY	5.68
31 ST080	BEARING PLATE SCREW	.34	74 BT057	BODY COVER SCREW	1.14
32 ST082	KICK LEVER GUIDE	1.14	76 GT318	HANDLE ASSEMBLY	6.31
33 ST040	BEARING PLATE	.85	77 GT073	HANDLE SCREW CAP	.69
34 RB028	BALL BEARING	5.73	78 ST046	REAR DRAG ADJ. WSHR.	1.03
35 ST060	RATCHET GEAR	1.83	79 ST120	ROTOR RET. SPRG. W/S	.85
36 ST011	PINION GEAR	3.44	80 GT005	BACK CLAW (FIGHTING)	1.09
37 GT301	BODY ASSEMBLY	10.95	81 GT018	FIGHTING CLICK WASHER	1.09
38 ST059	ANTI-REVERSE LEVER	.58			
39 ST068	CLICK CLAW	.39			
40 ST067	CLICK CLAW SCREW	.29			
41 ST104	SLIDER HOLDER	.63			

*Not shown in diagram
 Key 80 fits between keys 49, 50
 Key 81 fits between keys 52, 54

Prices subject to change without notice. Prices do not include postage and handling.

PLEASE ORDER BY PART NUMBER

Rev. 11/90

Zebco Division Brunswick Corporation, Box 270, Tulsa, OK 74101 USA 918-636-6681

